



INSTALLATION GUIDE - BRICK FACINGS

FACING DIMENSIONS

Face		Length (L)	Depth (D)	Thickness *(T)	Height (H)
	Standard	230mm	-	18mm	76mm
	Linear	287mm	-	18mm	48mm
	Standard	230mm	110mm	18mm	76mm
	Linear	287mm	90mm	18mm	48mm

*Actual product thickness may vary slightly

CONCRETE/MASONRY APPLICATION

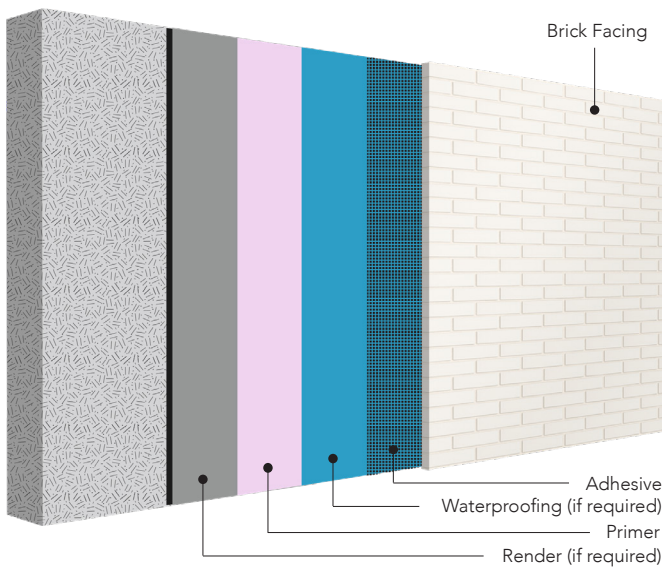

STUD WALL APPLICATION

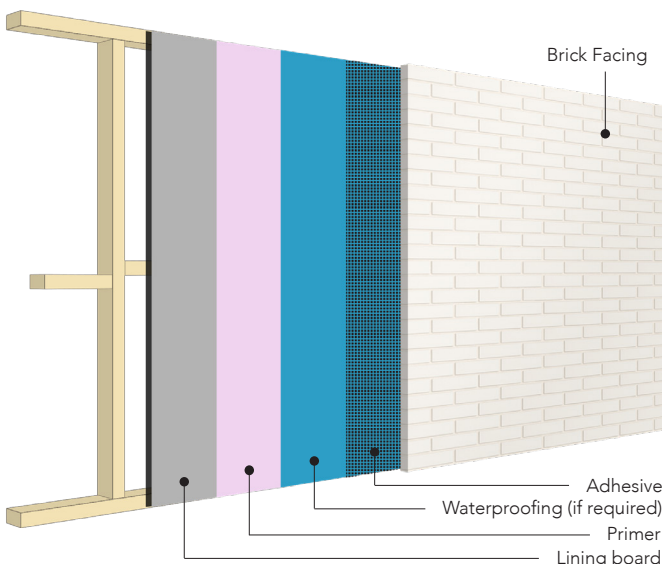

PREPARATION

Ensure the substrate is in sound condition, fit for purpose and has been suitably prepared, fixed and cured (where relevant) prior to the commencement of work. The substrate must be clean & free from dirt or any other foreign material that may inhibit the bonding process.

Porous surfaces (such as fibre-cement sheeting) should be primed with a suitable primer, and wet areas waterproofed with a suitable waterproofing system.

Ensure the brick facings are brushed clean to remove any dirt, dust, grime and debris prior to use.

INSTALLATION OF BRICK FACINGS

PGH Bricks recommends a proprietary adhesive be used. Ensure the adhesive is suitable for both clay masonry and the substrate being adhered to.

The adhesive being used must support the weight of the materials, and effectively fix the brick facings to the substrate being used. Brick facings will weigh approximately 38kg/m² excluding any adhesives/ mortars.

PLEASE NOTE

Brick facings, their fixings and grouting mortars do not constitute a waterproof barrier.

Follow all recommendations for usage and clean up provided by the supplier of the proprietary adhesive.

GROUTING AND POINTING OF JOINTS

PGH Bricks recommends the use of a proprietary cement mortar or grout.

Please follow the manufacturers guidelines regarding usage and clean up of excess mortar or grout.

LIMITATIONS:

It is recommended that for wall heights greater than 2.9m an Avante or Corium rainscreen façade system be considered. Please contact PGH Bricks & Pavers for further information.